

888.717.3003

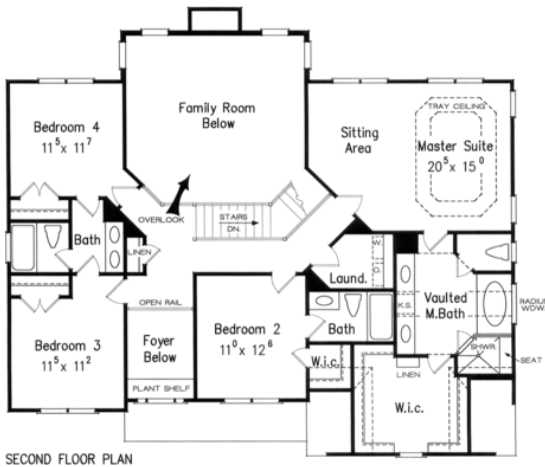

NEYLAND

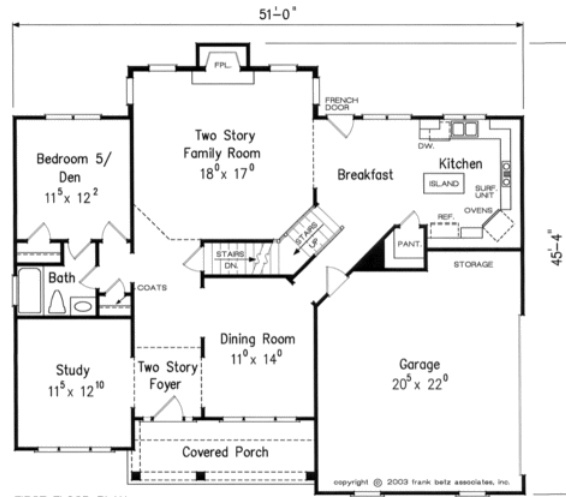

Square Footage

Total	2762
First Floor	1364
Second Floor	1398

Dimensions

Width	51' - 0"
Depth	45' - 4"
Height	33' - 4"

Floorplans and Elevations are subject to change. Floorplan dimensions are approximate. Consult working drawings for actual dimensions and information. Elevations are artists' conceptions. Photographs may have been modified from the original construction documents.

**2762 heated sqft. Build cost starting at approx. \$533,146.00 (slab foundation)
Add approximately \$42,000.00 for full unfinished basement**