

888.717.3003

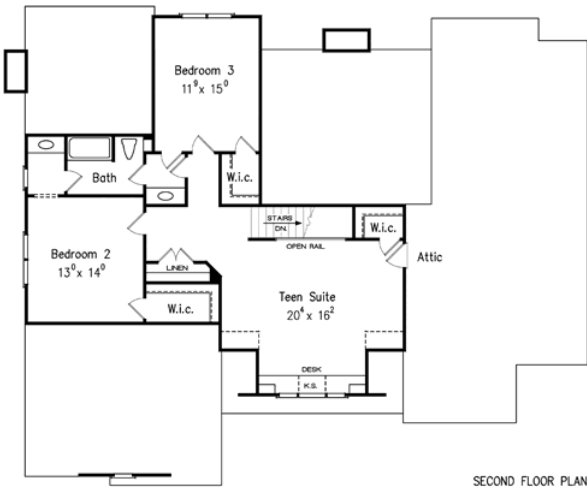

MCGINNIS FERRY

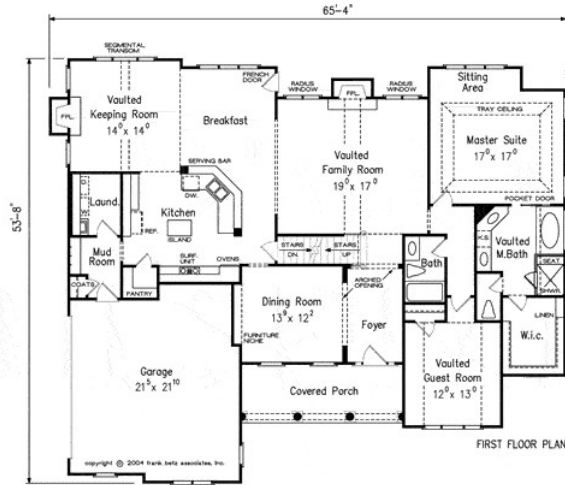
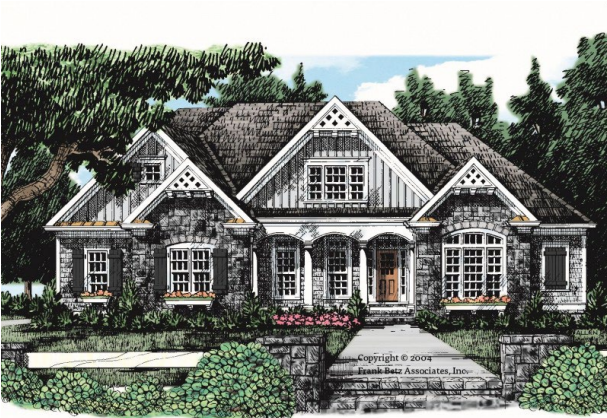

Square Footage

Total	3254
First Floor	2224
Second Floor	1030

Dimensions

Width	65' - 4"
Depth	53' - 8"
Height	29' - 0"

Floorplans and Elevations are subject to change. Floorplan dimensions are approximate. Consult working drawings for actual dimensions and information. Elevations are artists' conceptions. Photographs may have been modified from the original construction documents.

**3254 heated sqft. Build cost starting at approx. \$623,636.00 (slab foundation)
Add approximately \$65,000.00 for full unfinished basement**