



# The Ironwood Home Plan # W-1331-D



FLOOR PLAN  
PLAN NO. 1331-D



TOTAL SF - 3101  
82'9" W X 84'11" D  
MAIN LEVEL SF - 2111

FLOOR PLAN  
PLAN NO. 1331-D

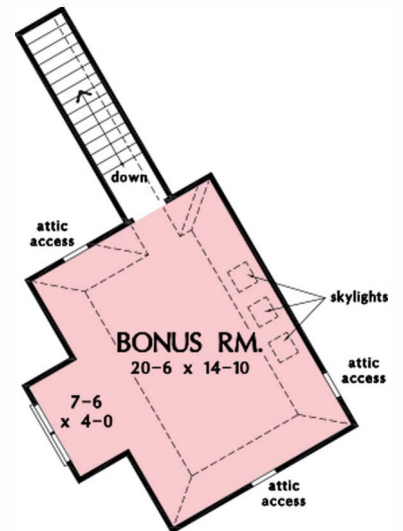

BONUS ROOM  
OPTIONAL BONUS ROOM SF - 359

3101 heated sqft.  
Build cost starting at approx. \$729,281.00.  
Add approx. \$32,000.00 for optional bonus room.  
Pricing does not include elevator.

Floorplans and elevations are subject to change.  
Floorplan dimensions and square footage is approximate.  
Elevations are artists' conceptions.



# The Ironwood Home Plan # W-1331-D



FLOOR PLAN  
PLAN NO. 1331-D

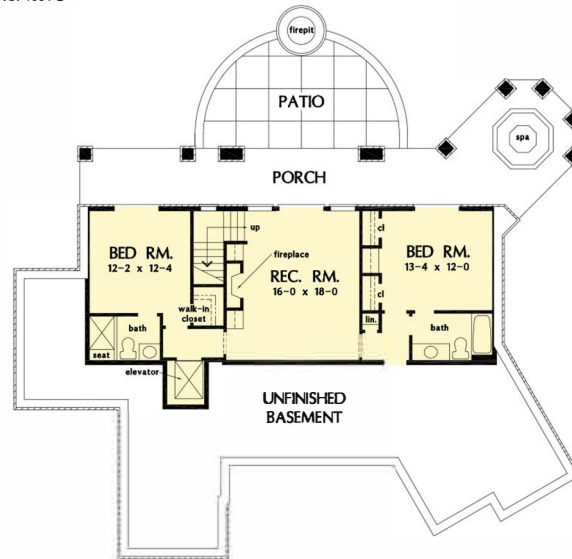

BASEMENT SF - 990

3101 heated sqft.  
Build cost starting at approx. \$729,281.00.  
Add approx. \$32,000.00 for optional bonus room.  
Pricing does not include elevator.

Floorplans and elevations are subject to change.  
Floorplan dimensions and square footage is approximate.  
Elevations are artists' conceptions.